

IMPLANT PROVISIONALS SPECIAL OFFER RX



4141 MacArthur Blvd. • Newport Beach, CA 92660
 800-854-7256 • Fax 800-411-9722 • glidewell dental.com

Dr. Name _____ Phone # _____

Patient ID/Name _____
First Last

Address _____

Email _____ **Deliver by 5 p.m. on** See Reverse for Working Times

Enclosed with Case: Impressions Models Bite Photos Other: _____

WEB RX

BioTemps
 Save \$10 per unit
 (up to 10 units)



Smile Transitions
 Save \$50
 per arch/quadrant
 (up to 2)

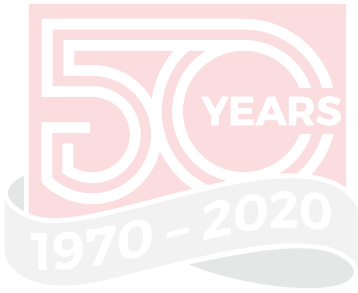
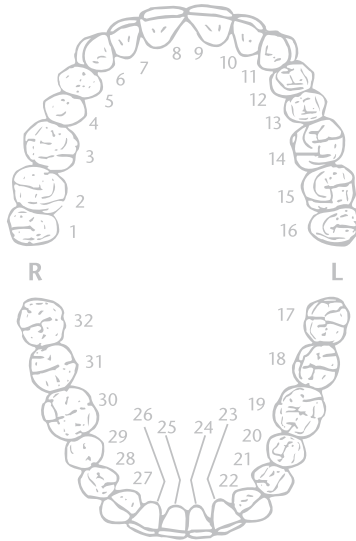

All Restorations
 Made in the USA

Signature _____
(see reverse for limited warranty details)

License # _____ Date _____

SMILE TRANSITIONS INSTRUCTIONS

Upper Lower Both arches/quadrants

Cosmetic Appliance Diagnostic Appliance
 Transitional Implant Appliance

Indicate shade here: _____

- Smile makeover—fabricate to ideal esthetics
- Open bite _____ mm anteriorly
- Lengthen incisal edge _____ mm
- Add length to gingival on tooth #(s) _____ by _____ mm
- Pontic site healing, prepare deep ovate socket on tooth #(s) _____ by _____ mm

PROVISIONALS SHADE



Indicate Shade Here

CHOOSE RESTORATION

- BioTemps Provisionals**
 • 6-month warranty
 Reinforcement: None Wire** Fiber
- Cast-metal substructure + 1 working day
- Essix Retainer** (1 tooth)
 • 30-day warranty
 No reinforcement available
- Smile Transitions Cosmetic Appliance**
 • Smile Transitions appliances are milled from an acetal resin block (no reinforcement)
 • Fabricated as a no-prep temporary solution
 • 1-year warranty

Upper: Tooth # _____ to Tooth # _____
 Lower: Tooth # _____ to Tooth # _____

Occlusion:
 Occlusal holes to maintain VDO
 No occlusal holes**

OFFER EXPIRES JAN. 31, 2021

**Price does not include shipping or applicable taxes. To save money on shipping, include multiple cases in one box. Limit one special offer per case. Web offer can only be used a maximum of one time per account.*

TOOTH NUMBER #(s) _____ to _____

Abutment** #(s) _____

Pontic #(s) _____

Extract #(s) _____

Splinted** #(s) _____

Open interproximal walls #(s) _____

Individual units #(s) _____

Veneer #(s) _____

Cement-on implant #(s) _____

Screw-retained implant #(s) _____

Amount of prep reduction: 1 mm** 2 mm

SELECT INCISAL EDGE TYPE



Rounded Squared Pointed

SELECT PONTIC DESIGN TYPE



**

PONTIC DESIGN

Perio treatment: Prepare tooth below gingival on tooth #(s) _____ by _____ mm

Perio site healing: Prepare ovate socket on tooth #(s) _____ by _____ mm

TERMS AND WARRANTY INFORMATION

We honor VISA, MASTERCARD, AMEX and DISCOVER.

TERMS: Cost of collection of any account will be paid by the customer. All accounts are payable within 30 days of statement date. **Accounts not paid within the stated terms will be subject to COD status and a late charge of 2 percent of the unpaid balance.** Prices subject to change without notice. Rx must be enclosed with original case submission.

NO-FAULT REMAKE POLICY: Glidewell is pleased to process all remakes or adjustments at no additional charge if requested within the warranty period and accompanied by the return of the original appliance.

LIMITED WARRANTY/LIMITATION OF LIABILITY. For warranty terms and conditions and limitation of liability, visit glidewell.com/policies-and-warranties.

BioTemps Provisionals 6-month warranty
Smile Transitions cosmetic appliance 1-year limited warranty
Essix retainer 30-day warranty

PREPARATION GUIDELINES

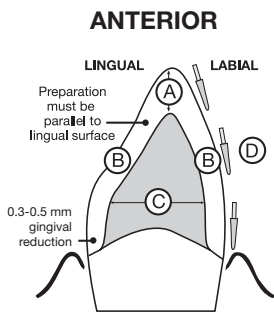

- A. 1.0 mm incisal reduction
- B. 0.8 mm middle third reduction
- C. Axial walls must be convergent (avoid undercuts)
- D. Preparation should be cut in three planes
- E. To achieve optimal impression quality, gingival retraction is necessary for preparations with subgingival or equigingival margins

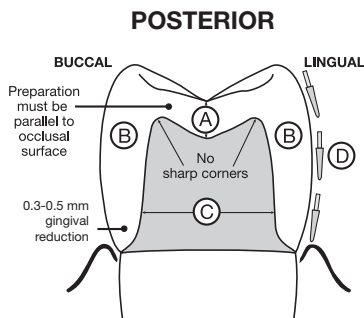

- A. 1.0 mm occlusal reduction
- B. 0.8 mm middle third reduction
- C. Axial walls must be convergent (avoid undercuts)
- D. Preparation should be cut in three planes
- E. To achieve optimal impression quality, gingival retraction is necessary for preparations with subgingival or equigingival margins

VENEERS

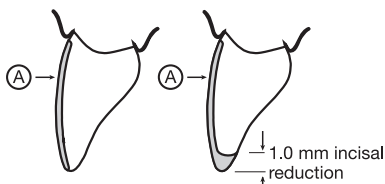

A. 0.3 to 1.0 mm labial reduction

LABIAL OR 360° MARGIN

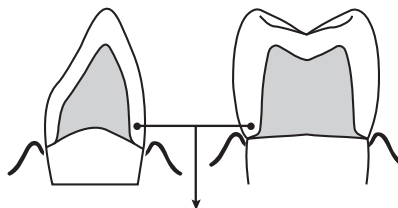

0.3-0.5 mm gingival reduction using rounded shoulder margin design

IN-LAB WORKING TIMES

Please allow full working time for each product selected.
 Working times are NOT guaranteed and do NOT include weekends or holidays.

BioTemps Provisionals 5 days
 w/ cast-metal frame or cast-metal reinforcement over implant 6 days
 screw-retained over implant 6 days
Smile Transitions cosmetic appliance 7 days
Essix retainer 4 days

Rush service available. Call for details.

PROVISIONALS RELINE INSTRUCTIONS

For best results, reline provisionals with a methyl methacrylate acrylic reline material (i.e., Luxatemp® Ultra by DMG America, Jet® by Lang, Coldpac by Yates Motloid or Palavit® 55 by Heraeus Kulzer). Other reline materials should be avoided. However, if used, mechanical undercuts must be cut into the abutment shells for better retention of the reline material.

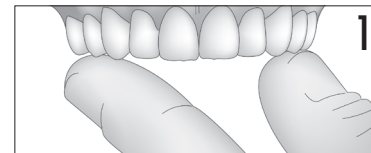

- Try in the restorations. If any adjustment is needed to seat the restoration, use a low-speed carbide or composite finishing bur.
- Rinse with water and dry completely.



- Apply a thin layer of petroleum jelly to the outer surface of the restoration to prevent excess reline material from sticking.
- Reline provisionals by blocking out any undercuts on the preparations.

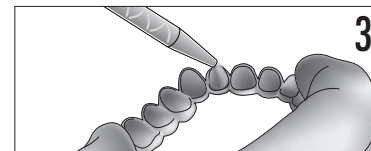

- Apply a minimal amount of reline material to the intaglio of the provisional. Use the mix tip to coat the inner walls with the material and evacuate any trapped air bubbles or voids.
- Do not allow the reline material to fully cure on the preparations due to heat generation, which may cause injury to the pulp.
- Gently work the provisional on and off the preps, allowing them to bench cure.

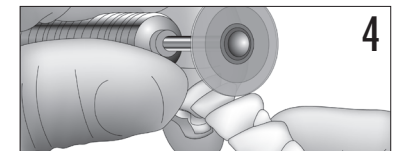

- Trim away any flash or excess acrylic using a plastic grinding disc.
- Provisionals can be polished with pumice and polishing paste or resealed with a light-cured glaze (e.g., Palaseal®, Heraeus Kulzer).
- Cement provisionals using a non-eugenol temporary cement. If higher retention is needed, Neo-Temp™ by Waterpik can be used.